



RADIANT & GEOTHERMAL PRODUCT CATALOGUE

PLB-SEY-1-2010

	PAGE	DISCOUNT CODE
RADIANT HEATING		
CANPEX™ Oxygen Barrier PEX	A2	6
Radiant Heating Manifolds	A3	8
Brass Straight Stops, Valves	A4	8
Copper Tee Drill Manifolds	A5	8
Radiant Heating Manifold Accessories & Parts	A6 - A10	2, 8
Radiant Heating Insert Fittings	A11 - A12	1, 2, 3
Radiant Heating Tools	A13	3, 8
GEOHERMAL		
Geothermal SDR-11 Pipe Coils & Straight Lengths	B1	9
Geothermal Schedule 40 Pipe Coils & Straight Lengths	B2	9
Geothermal SDR-11 Custom Uni-Coils	B2	9
Geothermal Socket Fusion IPS Fittings	B3 - B7	10
Geothermal Accessories	B8	10
Geothermal Socket Fusion Tools	B9 - B10	11

Seymour reserves the right to change pricing without notice, written or verbal.

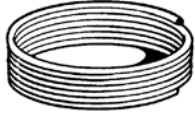

**CANPEX™ OXY
Oxygen Barrier PEX**

Coils
100 PSI @ 82.2 °C/180°F
160 PSI @ 23°C/73°F
SDR-9,CTS-OD
ASTM F876/F877/F2023
DIN 4726 STANDARD
CSA B137.5
THIRD PARTY CERTIFIED

NSF-pw

CAN/ULC S101/UL 263
CAN/ULC S102.2-3/E84

DISCOUNT CODE: 6

Part No.	Description	Coil Size	lbs./Coil
PX0B3C1	1/2" CANPEX™ OXY Tubing (5/8" OD)	100'	5.35 lbs.
PX0B3C2.5		250'	13.38 lbs.
PX0B3C3		300'	16.05 lbs.
PX0B3C5		500'	26.75 lbs.
PX0B3C10		1000'	53.50 lbs.
PX0B58C2.5	5/8 CANPEX™ OXY Tubing (3/4" OD)	250"	19.75 lbs.
PX0B58C3		300'	23.7 lbs.
PX0B58C4		400'	31.6 lbs.
PX0B58C5		500'	39.5 lbs.
PX0B58C10		1000'	79.0 lbs.
PX0B4C1	3/4" CANPEX™ OXY Tubing (7/8" OD)	100'	10.23 lbs.
PX0B4C2.5		250'	25.58 lbs.
PX0B4C3		300'	30.69 lbs.
PX0B4C5		500'	51.15 lbs.
PX0B4C10		1000'	102.30 lbs.
PX0B5C1	1" CANPEX™ OXY Tubing (1 1/8" OD)	100'	16.89 lbs.
PX0B5C2.5		250'	42.23 lbs.
PX0B5C3		300'	50.67 lbs.
PX0B5C5		500'	84.45 lbs.

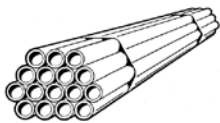

Straight
20' Lengths

DISCOUNT CODE: 6

Part No.	Description	Length Size	Bundle Size	lbs Bundle
PX0B3L5	1/2" CANPEX™ OXY Tubing (5/8" OD)	20'	500'	26.75
PX0B4L2	3/4" CANPEX™ OXY Tubing (7/8" OD)	20'	200'	20.46
PX0B5L1	1" CANPEX™ OXY Tubing (1 1/8" OD)	20'	100'	16.89

DISCOUNT CODE: 8

Part No.	Description
VGMC342S	2 Loop manifold with ball valves, thermometers and flow gauges
VGMC343S	3 Loop manifold with ball valves, thermometers and flow gauges
VGMC344S	4 Loop manifold with ball valves, thermometers and flow gauges
VGMC345S	5 Loop manifold with ball valves, thermometers and flow gauges
VGMC346S	6 Loop manifold with ball valves, thermometers and flow gauges
VGMC347S	7 Loop manifold with ball valves, thermometers and flow gauges
VGMC348S	8 Loop manifold with ball valves, thermometers and flow gauges
VGMC349S	9 Loop manifold with ball valves, thermometers and flow gauges
VGMC350S	10 Loop manifold with ball valves, thermometers and flow gauges

*Manual air vents available through special orders

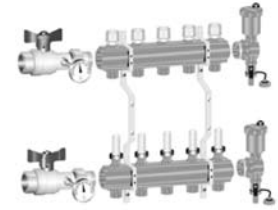

1" Pre-Assembled Manifold

With red and blue butterfly handle isolator ball valves, thermometers, automatic airvents, fill port, flow meters and mounting brackets.

DISCOUNT CODE: 8

Part No.	Description
VGMC346S.25	6 Loop manifold with ball valves, thermometers and flow gauges
VGMC347S.25	7 Loop manifold with ball valves, thermometers and flow gauges
VGMC348S.25	8 Loop manifold with ball valves, thermometers and flow gauges
VGMC349S.25	9 Loop manifold with ball valves, thermometers and flow gauges
VGMC350S.25	10 Loop manifold with ball valves, thermometers and flow gauges

*Manual air vents available through special orders

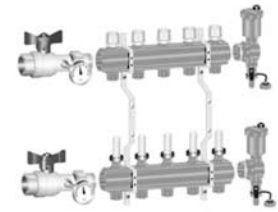

1 1/4" Pre-Assembled Manifold

With red and blue butterfly handle isolator ball valves, thermometers, automatic airvents, fill port, flow meters and mounting brackets.

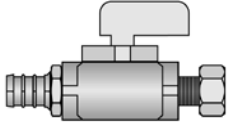

Straight Valve
Insert x Compression

DISCOUNT CODE: 8

Part No.	Description	Bag Wgt.	Bag Qty.
702010074C	1/2" Insert x 3/8 Comp Straight Stop Chrome Plated	.21	1
701800005	1/2" Insert x 5/8 Comp Balancing Valve (Brass)	.69	1
701810005	1/2" Insert x 5/8 Shut Off Valve (Chrome)	.67	1

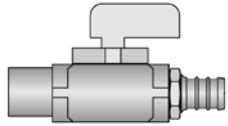

CF Sweat x Insert

DISCOUNT CODE: 8

Part No.	Description	Bag Wgt.	Bag Qty.
701213005C	1/2" Insert x Copper Female Sweat x Valve	.40	1
701211007C	3/4" Insert x Copper Female Sweat x Valve	.58	1

DISCOUNT CODE: 8

Part No.	Description	Box Wgt.	Box Qty.
710075003	3/4" Female Copper x 3 Branch (1/2") PEX x CLSD End	6.5 lbs.	10
710075004	3/4" Female Copper x 4 Branch (1/2") PEX x CLSD End	7.5 lbs.	10
710075005	3/4" Female Copper x 5 Branch (1/2") PEX x CLSD End	9.0 lbs.	10
710075006	3/4" Female Copper x 6 Branch (1/2") PEX x CLSD End	10.5 lbs.	10
710075007	3/4" Female Copper x 7 Branch (1/2") PEX x CLSD End	12.5 lbs.	10
710075008	3/4" Female Copper x 8 Branch (1/2") PEX x CLSD End	13.5 lbs.	10
710075009	3/4" Female Copper x 9 Branch (1/2") PEX x CLSD End	15.5 lbs.	10
710075010	3/4" Female Copper x 10 Branch (1/2") PEX x CLSD End	16.5 lbs.	10
710075011	3/4" Female Copper x 11 Branch (1/2") PEX x CLSD End	18.5 lbs.	10
710075012	3/4" Female Copper x 12 Branch (1/2") PEX x CLSD End	20.0 lbs.	10
710575003	3/4" PEX x 3 BR (1/2") PEX, 2" Center x CLSD End	8.0 lbs.	10
710575004	3/4" PEX x 4 BR (1/2") PEX, 2" Center x CLSD End	9.5 lbs.	10
710575006	3/4" x PEX x 6 BR (1/2") PEX, 2" Center x CLSD End	12.0 lbs.	10
710575007	3/4" x PEX x 7 BR (1/2") PEX, 2" Center x CLSD End	14.0 lbs.	10
710575008	3/4" x PEX x 8 BR (1/2") PEX, 2" Center x CLSD End	15.0 lbs.	10
714009072	1 X 24 BR (1/2) PEX, 3" Center 72" PEX Header	32.0 lbs.	6
714009166	1 1/4" X 24 BR (1/2) PEX, 3" Center 72" PEX Header	27.5 lbs.	4



Copper Tee Drilled, Crimp-On Manifold

DISCOUNT CODE: 8

Part No.	Description	Box Wgt.	Box Qty.
713010070	1 X 1/2 - 24 BR - 72" Copper Header, 3" Center	29.5 lbs.	5
713010072	1 X 3/4 - 24 BR - 72" Copper Header, 3" Center	24.0 lbs.	4
713012070	1 1/4 X 1/2 - 24 BR - 72" Copper Header, 3" Center	28.0 lbs.	4
713012072	1 1/4 X 3/4 - 24 BR - 72" Copper Header, 3" Center	29.5 lbs.	4
713015072	1 1/2 X 3/4 - 24 BR - 72" Copper Header, 3" Center	27.5 lbs.	3
713020072	2 X 3/4 - 24 BR - 72" Copper Header, 3" Center	26.0 lbs.	2



Copper Tee Drilled, Sweat-On Manifold

DISCOUNT CODE: 8

Part No.	Description	Box Wgt.	Box Qty.
710085002	3/4" Female Copper x 2BR (5/8") Comp x CLSD End	4.9 lbs.	10
710085003	3/4" Female Copper x 3BR (5/8") Comp x CLSD End	6.5 lbs.	10
710085004	3/4" Female Copper x 4BR (5/8") Comp x CLSD End	7.5 lbs.	10
710085005	3/4" Female Copper x 5BR (5/8") Comp x CLSD End	9.0 lbs.	10
710085006	3/4" Female Copper x 6BR (5/8") Comp x CLSD End	10.5 lbs.	10
710085007	3/4" Female Copper x 7BR (5/8") Comp x CLSD End	12.5 lbs.	10
710085008	3/4" Female Copper x 8BR (5/8") Comp x CLSD End	13.5 lbs.	10
710085009	3/4" Female Copper x 9BR (5/8") Comp x CLSD End	15.5 lbs.	10
7100850010	3/4" Female Copper x 10BR (5/8") Comp x CLSD End	16.5 lbs.	10
7100850011	3/4" Female Copper x 11BR (5/8") Comp x CLSD End	18.5 lbs.	10
7100850012	3/4" Female Copper x 12BR (5/8") Comp x CLSD End	20.0 lbs.	10



Copper Tee Drilled, Compression Manifold



Automatic Air Flow Vent

DISCOUNT CODE: 8

Part No.	Description
419	Automatic Air Vent

Included in manifold



Manifold Thermometer

DISCOUNT CODE: 8

Part No.	Description
448B	Temperature Indicator

Included in manifold

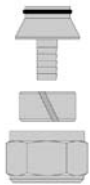

Compression x
Manifold Fitting

DISCOUNT CODE: 8

Part No.	Description
R2038CP	3/8" Manifold Adapter
R2012CP	1/2" Manifold Adapter
R2058CP	5/8" Manifold Adapter
R2034CP	3/4" Manifold Adapter

DISCOUNT CODE: 8



Circuit Actuators

Part No.	Description
AM24V	Manifold Actuator 24V, 2-Wire
AM24V4	Manifold Actuator 24V, 4-Wire

DISCOUNT CODE: 8

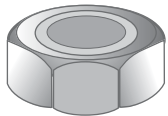

Circuit Cap

Part No.	Description
227	3/4" Manifold Circuit Cap

DISCOUNT CODE: 8



Zone Control

Part No.	Description
ZC4	Zone Control 4 Zones
ZC6	Zone Control 6 Zones

DISCOUNT CODE: 8

Part No.	Description
422R	Manifold Isolater Valve Red Handle

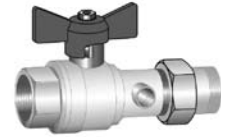

Manifold Isolater Valve
Red

DISCOUNT CODE: 8

Part No.	Description
422B	Manifold Isolater Valve Blue Handle

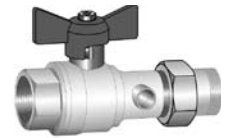

Manifold Isolater Valve
Blue

DISCOUNT CODE: 8

Part No.	Description
418T	Manual Air Flow Vent

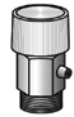

Manual Air Flow Vent

DISCOUNT CODE: 8

Part No.	Description
229	Fill Port Adapter



Fill Port Adapter

DISCOUNT CODE: 8

Part No.	Description
476A	Fill Port

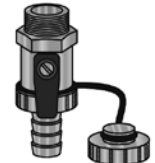

Fill Port

DISCOUNT CODE: 8

Part No.	Description
271	Manifold Bracket (Set of 2)

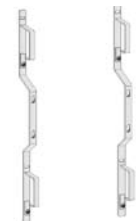

Manifold Brackets



Handle For Flow Meter

DISCOUNT CODE: 8

Part No.	Description
VOL4	Red Handle for Flow Meter



Flow Meter

DISCOUNT CODE: 8

Part No.	Description
GRM6	Flow Meter, 0-6 GPM



Return Valve Cap

DISCOUNT CODE: 8

Part No.	Description
399	Return Valve Cap



Digital Thermostat

DISCOUNT CODE: 8

Part No.	Description
TH115-A-24V	Programable ambient thermostat
TH115-AF-24T	Programable ambient floor thermostat
TH114-A-24T	Non programable ambient thermostat
TH114-AF-24T	Non programable ambient floor thermostat

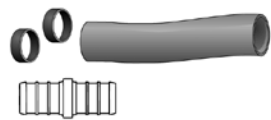

In-Slab Repair Kit

DISCOUNT CODE: 8

Part No.	Description	Bag Qty.
CBXRK33HR/ XPXRK33HR	1/2" In-Slab Repair Kit	1
CBXRK58HR/ XPXRK58HR	5/8" In-Slab Repair Kit	1
CBXRK44HR/ XPXRK44HR	3/4" In-Slab Repair Kit	1

*Available in both PAL & Brass

DISCOUNT CODE: 8

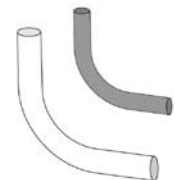

Plastic Slip-On Elbow for Slab

Part No.	Description
HRSL3	1/2" PEX Plastic Slip On Elbow for Slab
HRSL4	3/4" PEX Plastic Slip On Elbow for Slab

DISCOUNT CODE: 8

Part No.	Description
CLMR3	1/2" Plastic Pipe Tracking (13' length)
CLMR4	3/4" Plastic Pipe Tracking (13' length)

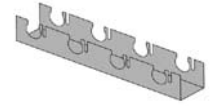

Fixing Rails

DISCOUNT CODE: 8

Part No.	Description
HTRP3	1/2" Heat Transfer Plates
TFIN38	1/2" x 8' Thermofin C Heat Transfer Plate, Thermofin Screws
TFINSCR	Screw for Transfer Plate (100/Bag)
TFINRDRV	Driver for Transfer Plate (100/Bag)

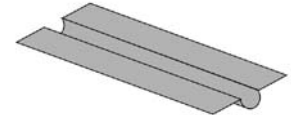

Heat Transfer Plates

DISCOUNT CODE: 2

Part No.	Description	Bag Qty.	Box Qty.
CLJ2	3/8" J-Clamp with Nail	100	500
CLJ3	1/2" J-Clamp with Nail	100	500
CLJ4	3/4" J-Clamp with Nail	100	500
CLJ5	1" J-Clamp with Nail	50	250

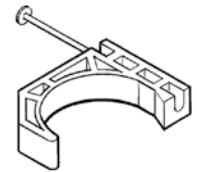

Tube Clamps

DISCOUNT CODE: 2

Part No.	Description	Bag Qty.	Box Qty.
CLE2	3/8" CTS Tubing Clamp	100	1000
CLE3	1/2" CTS Tubing Clamp	100	1000
CLE4	3/4" CTS Tubing Clamp	50	500



Tube Clips

DISCOUNT CODE: 2

Part No.	Description	Bag Qty.	Box Qty.
LCH3	1/2" Lock-Clip	100	1200
LCH4	3/4" Lock-Clip	50	600
LCH5	1" Lock-Clip	50	400



Lock-Clip

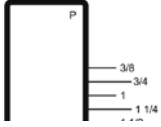

Staple for Pneumatic Stapler

DISCOUNT CODE: 8

Part No.	Description	Box Qty.
PSPL	Staple for Pneumatic Stapler	10,000



Rider Staple

DISCOUNT CODE: 8

Part No.	Description	Bag Qty.	Box Qty.
RS2.1	Rider Staple (For 3/8", 1/2" and 5/8" OD Tubing)	20	500

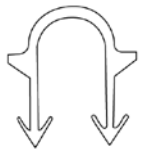

Foam Staple

DISCOUNT CODE: 8

Part No.	Description	Bag Qty.	Box Qty.
FSPL	Foam Staple (2 3/8" in length) (For 1/2", 5/8" OD Tubing)	30	300



Pneumatic Stapler

DISCOUNT CODE: 8

Part No.	Description	Box Qty.
PSGN	Pneumatic Stapler	1



Rider Staple Gun

DISCOUNT CODE: 8

Part No.	Description	Box Qty.
STAT1	Rider Staple Gun	1



Foam Staple Gun

DISCOUNT CODE: 8

Part No.	Description	Box Qty.
FSGP	Foam Stapler (For 1/2", 5/8" tubing)	1

DISCOUNT CODE: 2

Part No.	Description	Bag Qty.	Box Qty.
CBXFC23	3/8" Insert x 1/2" FPT	25	200
CBXFC33	1/2" Insert x 1/2" FPT	25	200
CBXFC34	1/2" Insert x 3/4" FPT	25	150
CBXFC44	3/4" Insert x 3/4" FPT	25	150
CBXFC55	1" Insert x 1" FPT	25	150

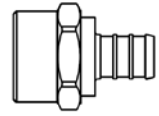

FPT Adapters
Insert x FPT

DISCOUNT CODE: 2

Part No.	Description	Bag Qty.	Box Qty.
CBXC23M	3/8" Insert x 1/2" Sweat (M)	50	500
CBXC33M	1/2" Insert x 1/2" Sweat (M)	50	500
CBXC58M	5/8" Insert x 3/4" Sweat (M)	50	500
CBXC44M	3/4" Insert x 3/4" Sweat (M)	25	300
CBXC55MC	1" Insert x 1" Sweat (M) (Copper)	10	100

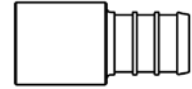

Male Sweat Adapters
Insert x Male Sweat

DISCOUNT CODE: 2

Part No.	Description	Bag Qty.	Box Qty.
CBXC33F	1/2" Insert x 1/2" Sweat (F)	50	500
CBXC584F	5/8" Insert x 3/4" Sweat (F)	50	500
CBXC44F	3/4" Insert x 3/4" Sweat (F)	25	250
CBXC55FC	1" Insert x 1" Sweat (F) (Copper)	10	50

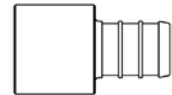

Female Sweat Adapters
Insert x Female Sweat

DISCOUNT CODE: 2

Part No.	Description	Bag Qty.	Box Qty.
CBXE23FC	3/8" Insert x 1/2" Sweat (F)	25	250
CBXE33FC	1/2" Insert x 1/2" Sweat (F)	50	500
CBXE44FC	3/4" Insert x 3/4" Sweat (F)	25	250

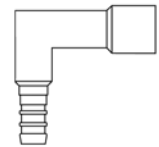

Sweat Elbows
Insert x Female Sweat

DISCOUNT CODE: 2

Part No.	Description	Bag Qty.	Box Qty.
CBXE23MC	3/8" Insert x 1/2" Sweat (M)	50	500
CBXE33MC	1/2" Insert x 1/2" Sweat (M)	50	500
CBXE44MC	3/4" Insert x 3/4" Sweat (M)	25	250

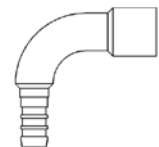

Sweat Elbows
Insert x Male Sweat



Black Copper Crimp Rings

DISCOUNT CODE: 7

Part No.	Description	Bag Qty.	Ctn Qty.
CBXCR2	Copper Ring for 3/8" Tubing	100	2000
CBXCR3	Copper Ring for 1/2" Tubing	100	1000
CBXCR58	Copper Ring for 5/8" Tubing	100	500
CBXCR4	Copper Ring for 3/4" Tubing	100	500
CBXCR5	Copper Ring for 1" Tubing	50	250

DISCOUNT CODE: 2

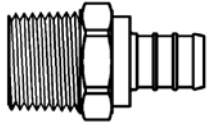

MPT Adapters
Insert x MPT

Part No.	Description	Bag Qty.	Box Qty.
CBXMC23/ XPMC23	3/8" Insert x 1/2" MPT	50	300
CBXMC33/ XPMC33	1/2" Insert x 1/2" MPT	50	300
CBXMC34/ XPMC34	1/2" Insert x 3/4" MPT	25	200
CBXMC43/ XPMC43	3/4" Insert x 1/2" MPT	25	250
CBXMC44/ XPMC44	3/4" Insert x 3/4" MPT	25	200
CBXMC55/ XPMC55	1" Insert x 1" MPT	10	50

*Available in both PAL & Brass

DISCOUNT CODE: 3

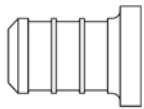

Plastic Test Plugs

Part No.	Description	Bag Qty.	Box Qty.
CBXP2	3/8" PLS (Plastic) Insert Test Plug	100	1000
CBXP3	1/2" PLS (Plastic) Insert Test Plug	100	1000
CBXP4	3/4" PLS (Plastic) Insert Test Plug	50	1000
CBXP5	1" PLS (Plastic) Insert Test Plug	25	500

DISCOUNT CODE: 3

Part No.	Description	Weight
HAD2	3/8" Full-Circle Crimper	4.20 lbs.
HAD3	1/2" Full-Circle Crimper	4.30 lbs.
HAD4	3/4" Full-Circle Crimper	4.90 lbs.
HAD5	1" Full-Circle Crimper	5.50 lbs.
HAD34	3/4" and 1/2" Crimper	4.90 lbs.

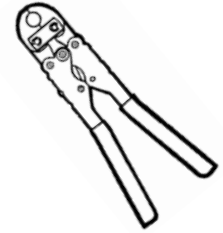

Crimp Tools

DISCOUNT CODE: 3

Part No.	Description	Weight
HCM2	Compact 3/8" Full-Circle Crimper	2.0 lbs.
HCM3	Compact 1/2" Full-Circle Crimper	2.1 lbs.
HCM4	Compact 3/4" Full-Circle Crimper	2.5 lbs.

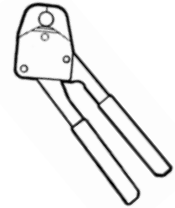

Crimpmaker™

DISCOUNT CODE: 3

Part No.	Description	Weight
EZ2	1/2" EZ2 Stroke Crimper	2.1 lbs.
EZ2	3/4" EZ2 Stroke Crimper	2.5 lbs.



EZ2 Crimp Tool

DISCOUNT CODE: 3

Part No.	Description	Weight
HAC234	Measures 3/8," 1/2" and 3/4" Finished Crimp by GO/NO-GO	0.11 lbs.

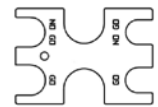

Crimp Caliper

DISCOUNT CODE: 3

Part No.	Description	Weight
HAK5M	Tube Cutter (up to 1-1/4" CTS)	0.12 lbs.
HAKB5M	Replacement Blade	0.07 lbs.



Tube Cutter

DISCOUNT CODE: 8

Part No.	Description	Weight
TATK200	Tube Uncoiler	30 lbs.

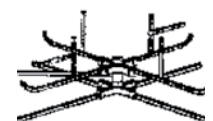

Tube Uncoiler

Continuous coils suitable for horizontal or vertical heat exchange loops.
 Coils greater than 200' in length are decrementally marked.

DISCOUNT CODE: 9

Part Number	Nominal Size	Minimum Wall	Coil Length	Weight Per Coil
BLA4C1	3/4" Nominal (1.05 OD, 0.85 ID)	.100	100'	13.0
BLA4C2			200'	25.9
BLA4C3			300'	38.8
BLA4C5			500'	64.7
BLA4C6			600'	77.6
BLA5C1			1" Nominal (1.32 OD, 1.08 ID)	.120
BLA5C2	200'	40.6		
BLA5C3	300'	60.9		
BLA6C1	1 1/4" Nominal (1.66 OD, 1.36 D)	.150	100'	32.2
BLA6C2			200'	63.7
BLA6C5			500'	161.0
BLA7C1	1 1/2" Nominal (1.90 OD, 1.56 ID)	.170	100'	40.4
BLA7C2			200'	80.9
BLA8C1	2" Nominal (2.38 OD 1.94 ID)	.220	100'	63.9
BLA8C2			200'	127.8
BLA8C2.5			250'	159.12



GEO-Black
 160 PSI, SDR-11
 IPS-OD
 CSA B137.1
 CSA C448
 PE4710
 ASTM D 3035

Orders for items involving special lengths not held in stock will require no less than 4 weeks lead time.
 Minimum orders may be required. Please inquire before ordering.

Suitable for construction of headers or connecting loops.

DISCOUNT CODE: 9

Part Number	Nominal Size	Minimum Wall	Bundle Qty.	Weight Per Bundle
BLA4L2	3/4" Nominal (1.05 OD, 0.85 ID)	.100	200' (10pcs)	26.0
BLA5L1	1" Nominal (1.32 OD, 1.08 ID)	.120	100' (5pcs)	20.5
BLA6L1	1 1/4" Nominal (1.66 OD, 1.36 ID)	.150	100' (5pcs)	32.2
BLA7L1	1 1/2" Nominal (1.90 OD, 1.56 ID)	.170	100' (5pcs)	40.4
BLA8L1	2" Nominal (2.38 OD, 1.94 ID)	.220	100' (5pcs)	63.2

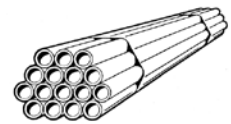

Straight
 20' Lengths

Items below are not held in stock and will require no less than 4 weeks lead time. Minimum orders may be required. Please inquire before ordering for availability in your region.

DISCOUNT CODE: 9

Continuous coils generally used for inground heat exchanger loops or for supply/return piping. Coils greater than 200' in length are decremenatly marked.



GEO-Black
 Schedule 40
 IPS-OD
 CSA B137.1
 CSA C448
 PE4710
 ASTM D 2447

Part Number	Nominal Size	Minimum Wall	Coil Length	Weight Per Coil
BDA6C1	1 1/4" Nominal (1.66 OD, 1.38 ID)	.140	100'	29.4
BDA6C2			200'	58.6
BDA7C1	1 1/2" Nominal (1.90 OD, 1.60 ID)	.150	100'	35.1
BDA7C2			200'	70.0
BDA8C1	2" Nominal (2.38 OD, 2.08 ID)	.150	100'	47.1
BDA8C2			200'	93.9

Suitable for construction of headers or connecting loops.

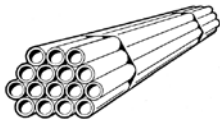

Straight
 20' Lengths

Part Number	Nominal Size	Minimum Wall	Bundle Qty.	Weight Per Bundle
BDA6L1	1 1/4" NOMINAL (1.66 OD, 1.38 ID)	.140	100' (5 pcs)	29.4
BDA7L1	1 1/2" NOMINAL (1.90 OD, 1.60 ID)	.150	100' (5 pcs)	35.1
BDA8L1	2" NOMINAL (2.38 OD, 2.08 ID)	.150	100' (5 pcs)	47.1

Custom length loops include two coils of pipe and U-Bend. Each loop is factory assembled and ready for installation. Have required loop length available when ordering. Item is available pressurized and capped with snifter valve if required.



Part Number	Size
UBA4N	3/4" Narrow U-Bend Assembly (2 1/2" Across)
UBA5N	1" Narrow U-Bend Assembly (3" Across)
UBA6	1 1/4" U-Bend Assembly

DISCOUNT CODE: 10

Part Number	Description	Wt.	Qty.
YFK644K02H	1 1/4" Inlet X (3) 3/4" Outlet	0.31	1
YFK644K03H	1 1/4" Inlet X (4) 3/4" Outlet	0.39	1
YFK644K04H	1 1/4" Inlet X (5) 3/4" Outlet	0.65	1
YFK644K05H	1 1/4" Inlet X (6) 3/4" Outlet	0.92	1
YFK644K06H	1 1/4" Inlet X (7) 3/4" Outlet	1.19	1
YFK844K07H*	2" Inlet X (8) 3/4" Outlet	1.95	1
YFK844K08H*	2" Inlet X (9) 3/4" Outlet	2.68	1
YFK844K09H*	2" Inlet X (10) 3/4" Outlet	3.99	1
YFK655K02H*	1 1/4" Inlet X (3) 1" Outlet	0.54	1
YFK655K03H*	1 1/4" Inlet X (4) 1" Outlet	1.02	1
YFK655K04H*	1 1/4" Inlet X (5) 1" Outlet	1.61	1
YFK655K05H*	1 1/4" Inlet X (6) 1" Outlet	1.76	1
YFK655K06H*	1 1/4" Inlet X (7) 1" Outlet	2.58	1
YFK855K07H*	2" Inlet X (8) 1" Outlet	3.17	1
YFK855K08H*	2" Inlet X (9) 1" Outlet	3.83	1
YFK855K09H*	2" Inlet X (10) 1" Outlet	4.65	1

*May require additional lead time.

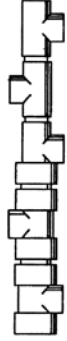

Geoheader Alternated
180° Fusion Header
Fusion x Fusion x Fusion

DISCOUNT CODE: 10

Part Number	Description	Wt.	Qty.
YFK644K02	1 1/4" Inlet X (3) 3/4" Outlet	0.31	1
YFK644K03	1 1/4" Inlet X (4) 3/4" Outlet	0.47	1
YFK644K04	1 1/4" Inlet X (5) 3/4" Outlet	0.55	1
YFK644K05	1 1/4" Inlet X (6) 3/4" Outlet	0.81	1
YFK644K06	1 1/4" Inlet X (7) 3/4" Outlet	1.08	1
YFK844K07*	2" Inlet X (8) 3/4" Outlet	2.25	1
YFK844K08*	2" Inlet X (9) 3/4" Outlet	2.68	1
YFK844K09*	2" Inlet X (10) 3/4" Outlet	4.00	1
YFK655K02*	1 1/4" Inlet X (3) 1" Outlet	0.54	1
YFK655K03*	1 1/4" Inlet X (4) 1" Outlet	1.03	1
YFK655K04*	1 1/4" Inlet X (5) 1" Outlet	1.34	1
YFK655K05*	1 1/4" Inlet X (6) 1" Outlet	2.02	1
YFK655K06*	1 1/4" Inlet X (7) 1" Outlet	2.58	1
YFK855K07*	2" Inlet X (8) 1" Outlet	3.17	1
YFK855K08*	2" Inlet X (9) 1" Outlet	3.83	1
YFK855K09*	2" Inlet X (10) 1" Outlet	4.67	1

*May require additional lead time.



Geoheader Parallel Fusion
Header Fusion x Fusion x Fusion



Fusion Couplings
Fusion x Fusion

DISCOUNT CODE: 10

Part Number	Description	Wt.	Bag Qty.
YFPC44	3/4" X 3/4"	2.25	25
YFPC54	1" X 3/4"	2.25	25
YFPC55	1" X 1"	2.25	25
YFPC64	1 1/4" X 3/4"	3.37	25
YFPC65	1 1/4" X 1"	3.00	25
YFPC66	1 1/4" X 1 1/4"	3.50	20
YFPC74	1 1/2" X 3/4"	1.72	15
YFPC75	1 1/2" X 1	1.80	15
YFPC76	1 1/2" X 1 1/4"	2.32	15
YFPC77	1 1/2" X 1 1/2"	2.17	15
YFPC85	2" X 1"	1.90	10
YFPC86	2" X 1 1/4"	1.65	10
YFPC87	2" X 1 1/2"	1.45	10
YFPC88	2" X 2"	1.40	10

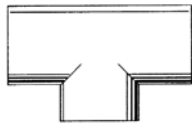

Fusion Tee
Fusion x Fusion x Fusion

DISCOUNT CODE: 10

Part Number	Description	Wt.	Bag Qty.
YFPT444	3/4" x 3/4" x 3/4"	2.25	25
YFPT554	1" x 1" x 3/4"	3.84	25
YFPT555	1" x 1" x 1"	2.47	15
YFPT644	1 1/4" x 3/4" x 3/4"	2.25	10
YFPT664	1 1/4" x 1 1/4" x 3/4"	2.25	10
YFPT655	1 1/4" x 1" x 1"	2.78	10
YFPT665	1 1/4" x 1 1/4" x 1"	3.05	10
YFPT666	1 1/4" x 1 1/4" x 1 1/4"	2.20	5
YFPT777	1 1/2" x 1 1/2" x 1 1/2"	1.45	5
YFPT884	2" x 2" x 3/4"	2.45	3
YFPT885	2" x 2" x 1"	1.47	3
YFPT888	2" x 2" x 2"	1.50	3

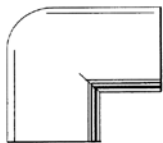

Fusion Elbow 90°
Fusion x Fusion

DISCOUNT CODE: 10

Part Number	Description	Wt.	Bag Qty.
YFPE44	3/4" x 3/4"	2.00	25
YFPE54	1" x 3/4"	3.00	25
YFPE55	1" x 1"	2.60	20
YFPE64	1 1/4" x 3/4"	3.50	20
YFPE65	1 1/4" x 1"	2.86	15
YFPE66	1 1/4" x 1 1/4"	4.05	10
YFPE77	1 1/2" x 1 1/2"	2.40	10
YFPE88	2" x 2"	2.10	5

DISCOUNT CODE: 10

Part Number	Description	Wt.	Bag Qty.
YFPCP4	3/4"	1.25	50
YFPCP5	1"	4.25	50
YFPCP6	1 1/4"	2.50	50
YFPCP7	1 1/2"	4.25	25
YFPCP8	2"	3.15	15

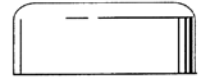

End Cap Fusion

DISCOUNT CODE: 10

Part Number	Description	Wt.	Bag Qty.
YFPEU44	Use with YFPE44 (U-DO 3/4" U-Bend)	1.37	25
YFPEU55	Use with YFPE55 (U-DO 1" U-Bend)	2.12	25
YFPEU66F	Use with YFPEU66M (U-DO 1 1/4" U-Bend)	1.85	10
YFPEU66M	Use with YFPEU66F (U-DO 1 1/4" U-Bend)	1.75	10

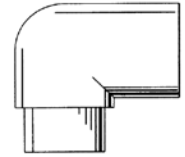

Fusion U-DO Elbow

DISCOUNT CODE: 10

Part Number	Description	Wt.	Bag Qty.
YFUB4N	3/4" Narrow U-Bend	0.52	1
YFUB4NC	3/4" Narrow U-Bend with Fusion Couplings	0.62	1
YFUB5N	1" Narrow U-Bend	0.80	1
YFUB5NC	1" Narrow U-Bend with Fusion Couplings	0.96	1
YFUB6	1 1/4" U-Bend	1.35	1
YFUB6C	1 1/4" U-Bend with Fusion Couplings	1.73	1
YFUB7	1 1/2" U-Bend	1.77	1
YFUB7C	1 1/2" U-Bend with Fusion Couplings	2.06	1

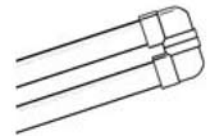

Fusion U-Bend Assembly

DISCOUNT CODE: 10

Part Number	Description	Wt.	Bag Qty.
YFPMA44	3/4" x 3/4" MPT	2.80	10
YFPMA45	3/4" x 1" MPT	4.62	10
YFPMA55	1" x 1" MPT	5.30	10
YFPMA64	1 1/4" x 3/4" MPT	4.24	10
YFPMA65	1 1/4" x 1" MPT	5.70	10
YFPMA66	1 1/4" x 1 1/4" MPT	7.85	10
YFPMA67	1 1/4" x 1 1/2" MPT	10.14	10
YFPMA77	1 1/2" x 1 1/2" MPT	5.00	5
YFPMA88	2" x 2" MPT	8.02	5

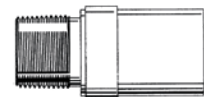

Male Adapter
Fusion x Male Adapter



Male Nominal Thread Couplings
Fusion x Male Nominal Thread

DISCOUNT CODE: 10

Part Number	Description	Wt.	Bag Qty.
YFPMC45S	3/4" X 1" MNT	6.00	25
YFPMC55S	1" X 1" MNT	5.87	25



Fusion Coupling with Female Adapter
Fusion x FPT

DISCOUNT CODE: 10

Part Number	Description	Wt.	Bag Qty.
YFPSC43	3/4" X 1/2" FPT	3.87	25
YFPSC53	1" X 1/2" FPT	6.54	25

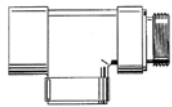

Fusion Male Threaded Heat Pump Tee
Fusion x Male Nominal Thread x FPT

DISCOUNT CODE: 10

Part Number	Description	Wt.	Bag Qty.
YFPMT453	3/4" x 1" MNT x 1/2" FPT	7.60	20
YFPMT553	1" x 1" MNT x 1/2" FPT	8.70	20
YFPMT555	1" x 1" x 1" FPT	3.40	10



Fusion Tee with Female Adapter
Fusion x Fusion x FPT

DISCOUNT CODE: 10

Part Number	Description	Wt.	Bag Qty.
YFPST443	3/4" x 3/4" x 1/2" FPT	4.20	20
YFPST553	1" x 1" x 1/2" FPT	5.30	20



Fusion Male Nominal Thread Elbow
Fusion x Male Nominal Thread

DISCOUNT CODE: 10

Part Number	Description	Wt.	Bag Qty.
YFPME45S	3/4" x 1" MNT	7.37	25
YFPME55S	1" x 1" MNT	6.37	25

DISCOUNT CODE: 10

Part Number	Description	Wt.	Bag Qty.
YFPSE43	3/4" x 1/2" FPT	4.80	25
YFPSE44	3/4" x 3/4" FPT	7.62	25

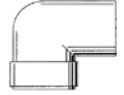

**Fusion Elbow with
Female Adapter**
Fusion x FPT

DISCOUNT CODE: 10

Part Number	Description	Wt.	Bag Qty.
YPFVA44	3/4" x 3/4"	4.40	5
YPFVA55	1" x 1"	4.26	5

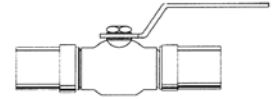

Fusion Ball Valve
Fusion x Fusion

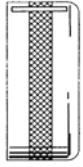

End Cap with Swivel Nut

DISCOUNT CODE: 10

Part Number	Description	Wt.	Bag Qty.
ECAP1	End Cap x 1" Swivel Nut	0.86	10

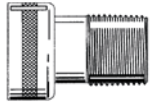

Swivel Nut Adapter
MPT x Swivel Nut Adapter

DISCOUNT CODE: 10

Part Number	Description	Wt.	Bag Qty.
MSA45G	3/4" MPT X 1" Swivel Nut	0.37	1
MSA55G	1" MPT X 1" Swivel Nut	0.45	1

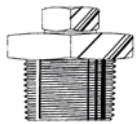

Pressure/Temperature
(PT) Plug

DISCOUNT CODE: 10

Part Number	Description	Wt.	Bag Qty.
HVPT50BE	1/2" MPT (PT) Plug (Brass)	3.35	20



PT Plug Probe

DISCOUNT CODE: 10

Part Number	Description	Wt.	Bag Qty.
HVTPGA1	Pressure Gauge Probe	.075	1



Nylon "Slinky" Bundle Ties

DISCOUNT CODE: 10

Part Number	Description	Wt.	Bag Qty.	Box Qty.
HB14120	Nylon Slinky Tie	1.34	100	1000

Each kit contains the tools required to fuse the indicated pipe size with proper fittings. All kits are packed in a tool box and contain: Heating Tool, Socket Face Set, Depth Gauge, Cold Ring, Hex Keys, Mounting Brackets, Tubing Cutter, Tempstiks, Timer, Tool Cover Bag, Screwdriver and a Cotton Wipe Rag. Heating equipment is 110 volt.



Complete Fusion Kits

DISCOUNT CODE: 11

Part Number	Description	Wt.	Qty.
FHAK4P	3/4" IPS - Single	13.61	1
FHAK4WDP	3/4" IPS - Double	13.86	1
FHAK5P	1" IPS - Single	13.82	1
FHAK5WDP	1" IPS - Double	15.96	1
FHAK6P	1 1/4" IPS - Single	15.40	1
FHAK6WDP	1 1/4" IPS - Double	15.65	1
FHAK7P	1 1/2" IPS - Single	15.86	1
FHAK7WDP	1 1/2" IPS - Double	16.11	1
FHAK8P	2" IPS - Single	16.43	1
FHAK8WDP	2" IPS - Double	16.67	1
FHAK46P	3/4" and 1 1/4" IPS - Single	17.06	1
FHAK46WDP	3/4" and 1 1/4" IPS - Double	15.73	1
FHAK48P	3/4" thru 2" IPS - Single	23.98	1
FHAK48WDP	3/4" thru 2" IPS - Double	23.98	1

DISCOUNT CODE: 11

Part Number	Description	Wt.	Qty.
FHDG4P	3/4" IPS	0.04	1
FHDG5P	1" IPS	0.07	1
FHDG6P	1 1/4" IPS	0.10	1
FHDG7P	1 1/2" IPS	0.14	1
FHDG8P	2" IPS	0.19	1



Depth Gauge

DISCOUNT CODE: 11

Part Number	Description	Wt.	Qty.
FHMB	Fusion Tool Mounting Bracket	1.24	1



Fusion Tool Mounting Bracket



Fusion Timer

DISCOUNT CODE: 11

Part Number	Description	Wt.	Qty.
FHFT	Fusion Timer	0.28	1



Fusion Tool Heat Bag

DISCOUNT CODE: 11

Part Number	Description	Wt.	Qty.
FHHB	Fusion Tool Heat Bag	0.98	1



Tempstik Temperature Indicator

DISCOUNT CODE: 11

Part Number	Description	Wt.	Qty.
FHS500	TEMPSTIK 500°F	0.05	1
FHS525	TEMPSTIK 525°F	0.07	1



Heating Tool 110 Volts

DISCOUNT CODE: 11

Part Number	Description	Wt.	Qty.
FHVT48	Heat Fusion Tool/Single Socket Face	2.74	1
FHVT48	Heat Fusion Tool/Double Socket Face	2.98	1

All heat fusion tools are thermostatically controlled.

Note: Seymour offers a tool repair program for crimp tools and fusion tools. Contact Seymour direct for complete information.



Socket Face

DISCOUNT CODE: 11

Part Number	Description	Wt.	Qty.
FHSF4P	3/4" IPS	0.34	1
FHSF5P	1" IPS	0.43	1
FHSF6P	1 1/4" IPS	0.57	1
FHSF7P	1 1/2" IPS	0.90	1
FHSF8P	2" IPS	1.27	1



Cold Ring

DISCOUNT CODE: 11

Part Number	Description	Wt.	Qty.
FHCR4P	3/4" IPS	0.99	1
FHCR5P	1" IPS	1.12	1
FHCR6P	1 1/4" IPS	1.24	1
FHCR7P	1 1/2" IPS	1.31	1
FHCR8P	2" IPS	1.47	1



T. 888.258.3370 | WWW.SEYMOURIND.COM